

Years of experience partners together to scale new heights

A PROJECT JOINTLY DEVELOPED BY



FORTUNE PARTNERS

IT'S THOUGHTFUL. IT'S **Rustomjee®**

**LE RÊVE | KHAR WEST**

**CALL: 6111 6111 | SMS: 'HOMES' TO 566778 | WWW.RUSTOMJEE.COM**

**SITE ADDRESS:** LE RÊVE, DR.AMBEDKAR ROAD, KHAR (W), MUMBAI - 400 052.

**CORPORATE OFFICE:** 702, NATRAJ, M.V. ROAD JUNCTION, WESTERN EXPRESS HIGHWAY, ANDHERI (E), MUMBAI - 400 069.

**Brochure Disclaimer:** Subject to approval of the authorities or in the interest of the continuing improvement, the promoters/developers reserve the right to change plans, specifications or features without prior notice or obligation.  
**Tolerance of +/- 3% is possible in unit areas on account of design and construction variance.**



## THEY'VE DESIGNED HOMES FOR MUMBAI'S GLITTERATI. YOURS TOO COULD BELONG TO THAT LIST.

Le Rêve is a classic creation of the award-winning firm Talati and Panthaky Associated, headed by celebrated architects Noshir D. Talati and Nozer R. Panthaky. With individual careers spanning over four decades in the business, Talati and Panthaky have designed homes for the creme de la creme of Mumbai's rich and famous, from top businessmen to celebrity movie stars. Experience that has endowed them with an intuitive understanding of exclusive tastes in design and decor.

Not believers in ephemeral fashion and fleeting style, the objective of physical and aesthetic endurance features prominently in their design. Impeccable in its detailing and quality of finish, the firm devotes equal attention to the exterior façade as to the minutest aspects of the interior.

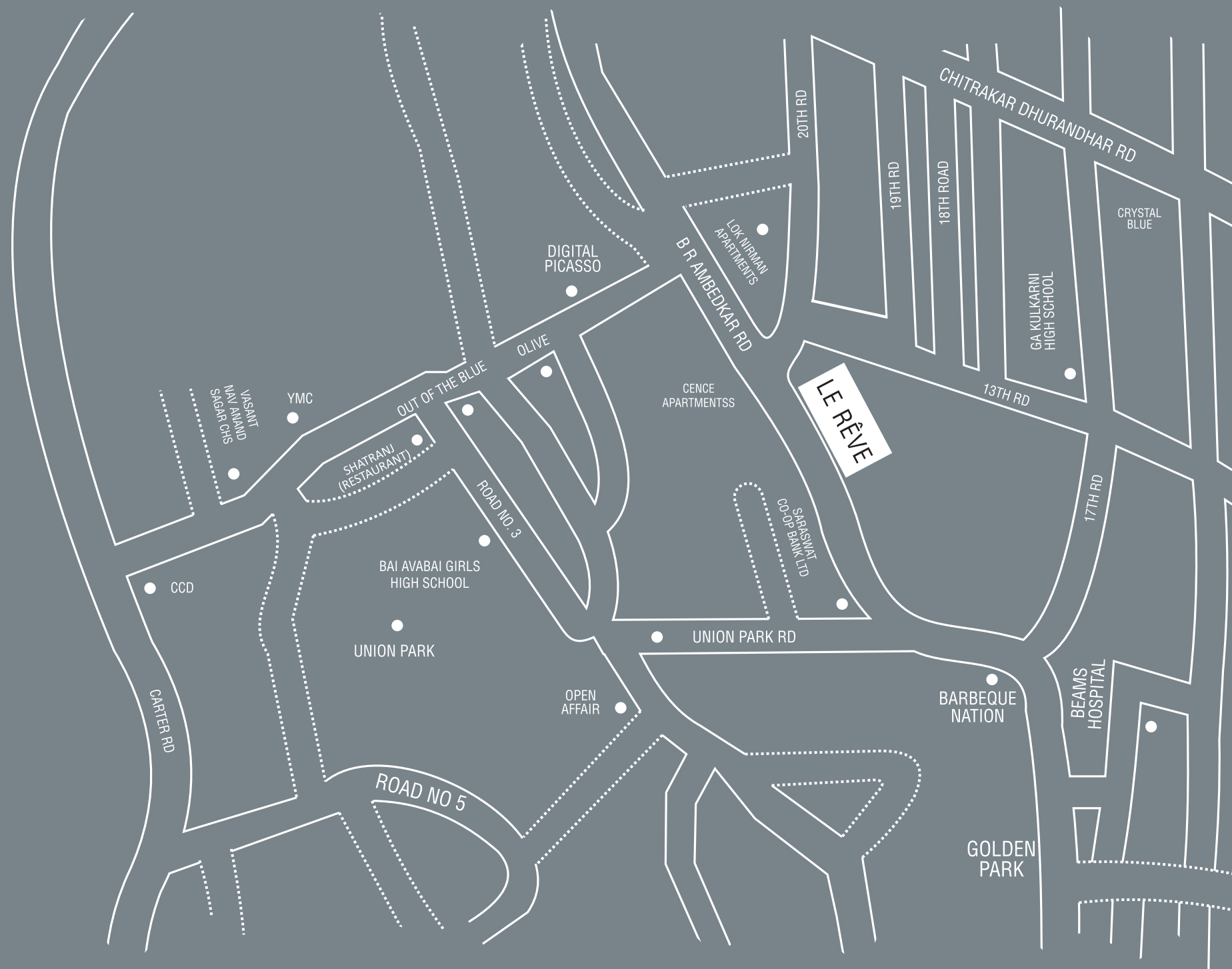

MORE THAN 25 RESTAURANTS,  
15 CLUBS, 5 SCHOOLS, 30 FASHION  
BOUTIQUES AND 2 MULTIPLEXES

## ALL IN THE NEIGHBOURHOOD.

Le Rêve is a boutique residential development adorning the skyline of one of Mumbai's most upscale locales - Khar West. Situated at one end of the serene Pali Hill, the standalone building is a stone's throw away from some of Mumbai's choicest gourmet hotspots. From bistros and bakeries to pubs and fine-dine restaurants, there are options galore for a bite out. Located minutes away from Linking Road, a bustling shopping destination lined with stores of international fashion labels, and with Carter Road just around the block, Le Rêve stands in the midst of a haven for epicureans.

The neighbourhood boasts some of the finest heritage schools, so your little ones can run back home when the school bell rings.

Added to all this is Le Rêve's proximity to the Western Express Highway ensuring an escape from serpentine traffic jams. So you can get home early enough for some Pictionary time with the family.





## RESIDENCES

Le Rêve has sprawling, well-ventilated 2 and 3.5 BHKs with parking space. Distinct for its exclusivity, it houses no more than a select few families and offers a quality of life coveted by all. Equipped with 2 high-speed Passenger Elevators and a Goods/Stretcher Elevator, it also has an extremely reliable security system in place. Owning a home in Le Rêve is a statement well made.

### Internal Amenities

- Elegant veneered entrance door with P.U. finish
- Polished veneered flush doors for bedrooms
- Provision for additional safety door
- Spacious living room perfect for getting together with family and friends
- Provision for high wall Split AC
- Exquisite timber deck in larger apartments
- Premium Italian marble flooring for entry foyer, passage, living and dining rooms
- Classy wooden flooring in master bedroom
- Energy efficient glass and aluminium windows making way for ample air and sunlight
- Sun-kissed balcony with glass railing, SS fixtures and handrail
- Modular light switches: Legrand/Clipsal or equivalent
- Spacious, contemporary kitchen space with granite/corian kitchen platform
- Vitrified tile kitchen flooring
- Stylish international bathroom sanitary ware: Kohler/American Standard/Roca or equivalent



#### External Conveniences

- Designer entrance lobby with polished imported marble and veneer paneling
- Security video door phone at the lobby and apartment entrance
- Intercom facility connecting every home to the in-house security
- Parking space
- Vicinity to parks, gymnasiums and clubs

Le Rêve is a landmark address that provides easy access to every imaginable comfort you may seek. It's where contemporary technology and luxuries meet thoughtful design and planning. With Le Rêve it's safe to say, the partnership between Fortune and Lok Housing has scaled new heights.

# TYPICAL FLOOR PLAN





2 BHK

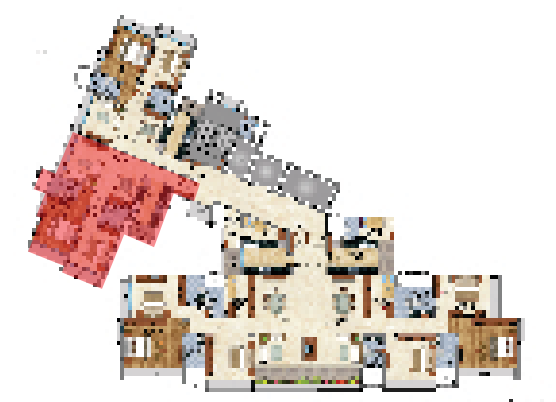



3.5 BHK

