



CJR
ORILE
MALAD EAST

the new address of luxury

a towering multistoried edifice



beautifully crafted abodes

usher a sense of calm

CJR
ORILE
MALAD EAST

ORILE, the new address of luxury. A Towering multistoried edifice, with beautifully planned 2 BHK flats, it is a pristine addition to the evolving city skyline. Located in the ever growing suburb of Malad (East) it is well connected with Western Express Highway & 5 mins from railway station, where the finest dining, educational, shopping and wonderful entertainment are merely steps away from you.

Invite yourself to an avante-garde lifestyle which is centrally located, luxuriously appointed and comfortable. Designed to elevate your apartment experience with lavishly appointed spaces and ultra modern facilities, these dwellings offer panoramic views of the city landscape from every angle to inspire and comfort you. Beautifully crafted abodes that usher a sense of calm and tranquility into the lives of those who seek sanctuary here.





The Lifestyle

- Earthquake Resistance Structural Design
- Stack Car Parking System
- 2 High-speed Passenger Elevators
- Video Door phone | CCTV surveillance system
- Both Side laminated Flush doors
- Granite Kitchen Platform with Nirali Stainless Steel Sink
- Anodized Heavy Gauge Sliding Windows | MS Safety Grill
- Alfa Water Purifier
- Simpolo Double Charged Vitrified Flooring
- Jaquar CP Fittings Recold instant geyser
- Simpolo Sanitaryware
- Somany Anti- skid flooring
- Water Repellant Acrylic Paint on External walls to ensure long life of building
- Fire Fighting Mechanism with sprinkler system

CJR
ORILE
MALAD EAST

The Neighbourhood

- 5 minutes from Western Express Highway.
- Malad Station - 2 kms & Goregaon Station - 3 kms.
- Easy access to S. V. Road and Link Road.
- Aarey Colony - a mere ten minute walk from the address.
- Airport just 10 minutes drive away from ORILE.
- Shares the vicinity with the finest of Malls (Oberoi Mall) & premium Retail Outlets, Schools and Colleges, Hospitals and Health Care Centers, Hotels & Restaurants.



Actual Pictures of Sample Flat



About the Group

CJR is a young and skilled team of professionals who have a passion to set new standards for quality work and the zeal to go great lengths to ensure an impeccable business experience for our clients. We are one of the fastest growing real estate development companies in Mumbai with more than one million square feet developed to our credit. The company has partnered some of the biggest names in the real estate arena.

Besides, property leasing being a diversified branch of our core competencies, we have leased 100,000 sq. ft. of premium commercial spaces to an elite clientele that includes some forerunning financial institutions and MNC's. Also, with their upcoming projects in the suburban Mumbai, CJR is set to raise the bar.



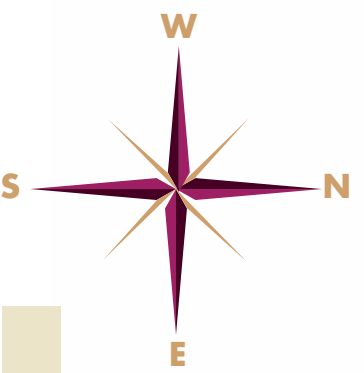

Typical Floor Plan

G G MAHALKARI ROAD

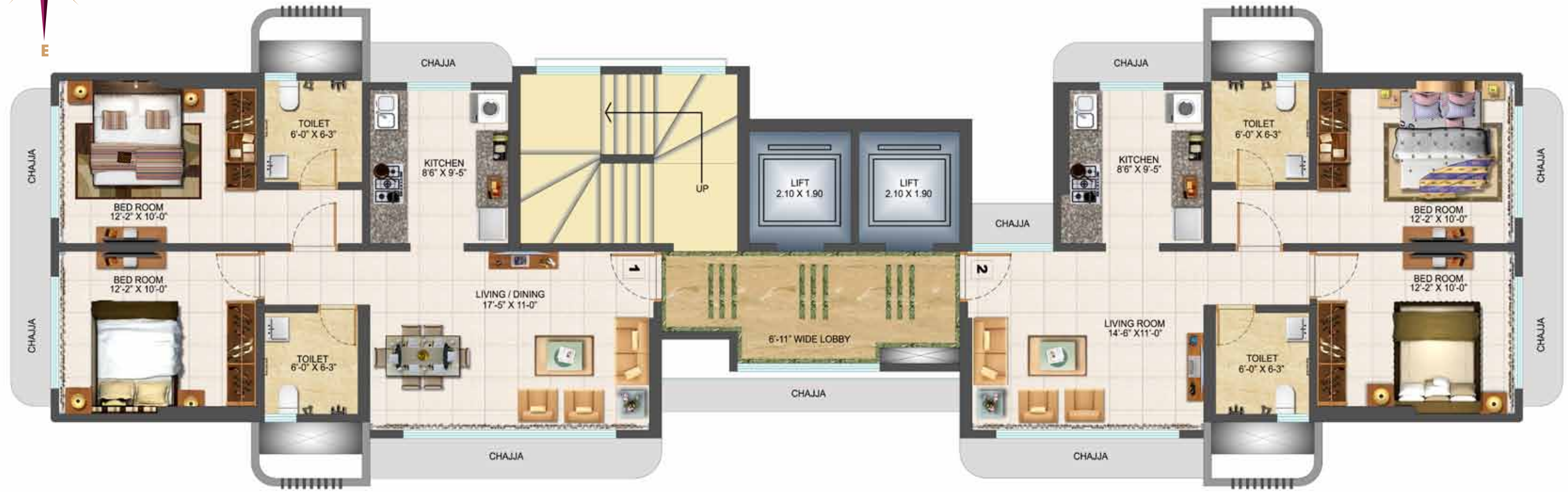

3D View of the Apartment



The Location

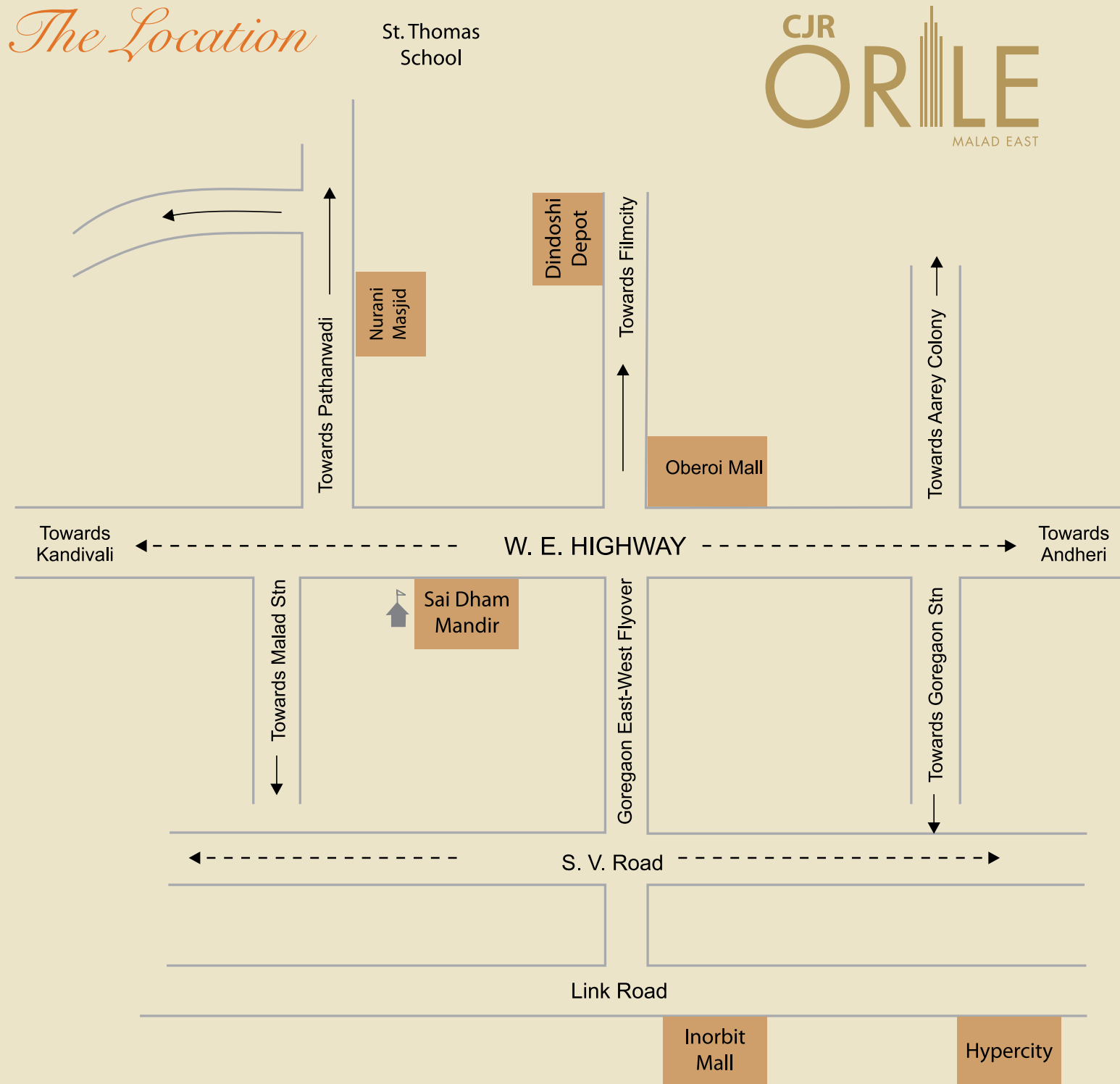



SITE ADDRESS

"CJR ORILE", G. G. Mahalkari Road,
Vaishat Pada, Near Triveni Nagar,
Off Pathanwadi, Malad (East), Mumbai.

RUMAO DEVELOPERS

3rd Floor, Acme Shopping Arcade,
Trikamdas Road, Kandivali (West),
Mumbai - 400067.

Tel: +91 - 22 - 6127 6127 / 6128

E-mail: contact@cjrgroup.in

Web: www.cjrgroup.in

The Information contained in the brochure is indicative of the kind of development that is proposed. It is prepared and issued in good faith and is for guidance only. It does not constitute part of an offer or contract. Subject to the approval of the authorities or in the interest of the continuing improvement, the developers reserve the right to alter the layout, plans, specifications or features without prior notice or obligation.